

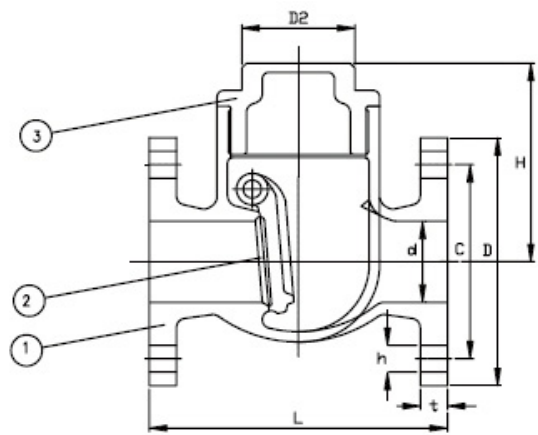

MARINE BRONZE 5K LIFT CHECK VALVE - JIS F7356

MARINE BRONZE 5K SWING CHECK VALVE - JIS F7371

Manufactured in accordance to JIS F7400
Flanges as per JIS B2220 - 5K

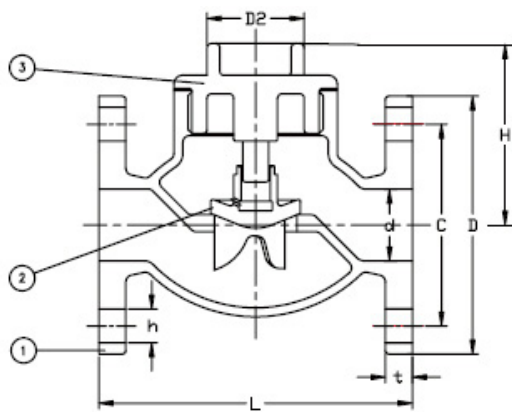

No.	Component	Material
1	Body	Bronze
2	Disc	Bronze
3	Bonnet	Bronze

Nominal Pressure		5K
Hydraulic Inspection	Body	10.5kg
	Seat	4~7.3kg

Type	Size	L	D	C	No.	h	t	H	D2	Kg
F7356 LIFT CHECK 5K	25A	120	95	75	4	12	10	77	41	2.39
	32A	140	115	90	4	15	12	81	41	3.80
	40A	160	120	95	4	15	12	91	46	4.95

Type	Size	L	D	C	No.	h	t	H	D2	Kg
F7371 SWING CHECK 5K	25A	110	95	75	4	12	10	69	41	2.24
	32A	130	115	90	4	15	12	79	41	3.07
	40A	140	120	95	4	15	12	93	46	4.34